



## Battery Lothringen

Dominating the headland at Noirmont Point, Lothringen is the only German naval coastal artillery battery in Jersey.

### M-132 Command Bunker

Extending to a depth of 40ft. on two floors, this impressive bunker was the Command Post (Leitstand) for the battery. One of four built to a similar design in the Channel Islands, the bunker was surmounted by a range-finder and two periscopes to determine the distance and speed of sea targets.

### MP-1 Coastal Artillery Observation Tower

This massive structure known as a 'Marine Peilstand' or 'Naval direction-finding tower', is one of three constructed in Jersey, out of a planned total of nine. The observation slits, set in two metres of concrete, provide an impressive setting for the distant sea views towards France. On top of the tower is a mounting for a 2cm Flak Oerlikon anti-aircraft gun.

 Nearest stop #3574  
Portelet Bay

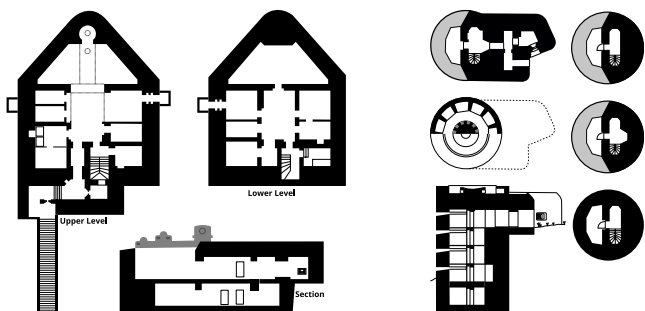

## Membership Application and Renewal Form

### Annual Subscription Rates

British Channel Islands / U.K. Members:

Single: £18  Couple: £27  Junior (>16): £13.50   
Family: £27 + £6/child

E.U. Members: €25 or £23  Rest of the World: £30

*(Members joining after 1st November automatically qualify for the next year)*

### Members Details

Your Name:

Address:

Telephone:

Email:

### Declaration

I / We agree to be bound by the rules of the Channel Islands Occupation Society (Jersey).

Signature:

Date:

### Payments

£GBP: You may pay cash or cheque at any bunker opening. Please make cheques payable to CIOS (Jersey) Ltd.

€ or \$USD: Please use Euro or US Dollar notes only, or contact the Secretary for instructions.

### Company Address

Channel Islands Occupation Society (Jersey) Limited  
PO Box 95  
JE4 5PB  
JERSEY

Contact us: [secretary@cios.org.je](mailto:secretary@cios.org.je)

Join online at [cios.org.je](http://cios.org.je)

# FORTIFICATIONS GUIDE

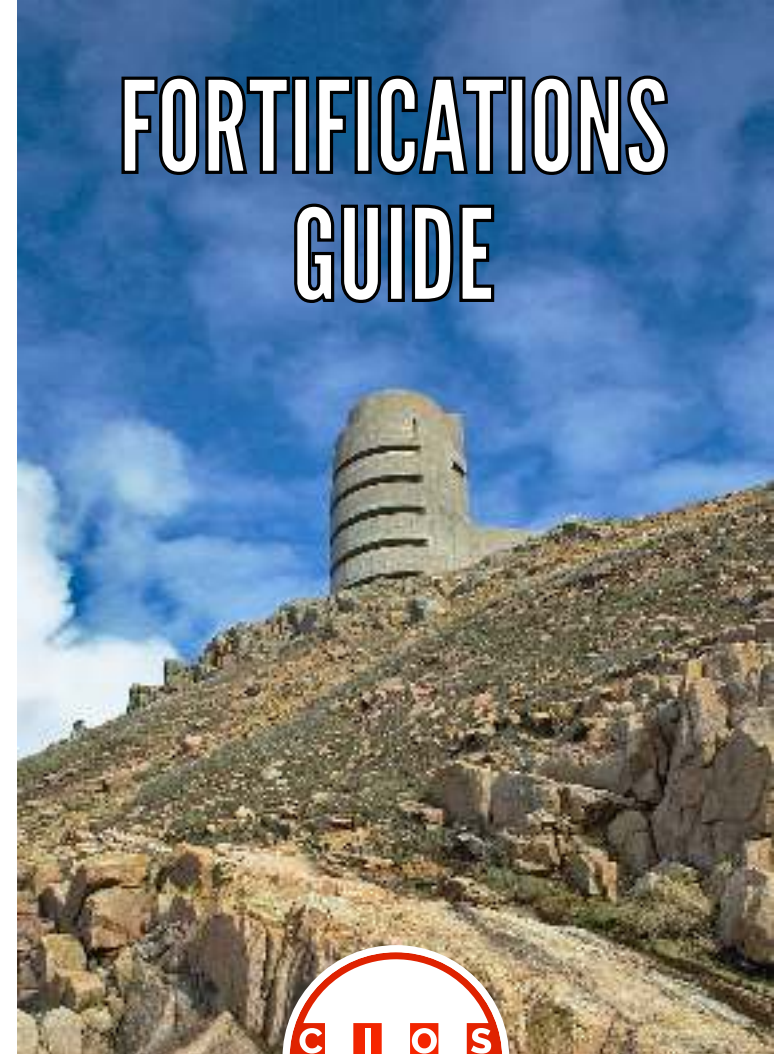

## Channel Islands Occupation Society (Jersey)

The best-preserved collection of German Second World War defence works in Western Europe

**All Bunkers Open to the Public**  
See website for maps & open times  
[www.cios.org.je](http://www.cios.org.je)



## Battery Moltke

### 15.5cm Gun Emplacements & Underground Bunker

There are few distinguishing landmarks, but look for the signs at the entrance to the track onto Les Landes Common at the top of the steep hill above L'Etacq.

This is a restored section of the army battery 'Moltke' which once sprawled across the headland. On permanent exterior display is one of the original 15.5cm K418(f) French field guns from the battery, initially pushed over the nearby cliffs by the British Army in 1946, and retrieved in the 1990s.

In an adjacent emplacement are further examples of coastal artillery pieces used in the Island, and subsequently rescued from the same watery grave. Below ground, there is an extensive complex of passage-linked personnel and ammunition bunkers.

 Nearest stop #3235  
Les Landes Common

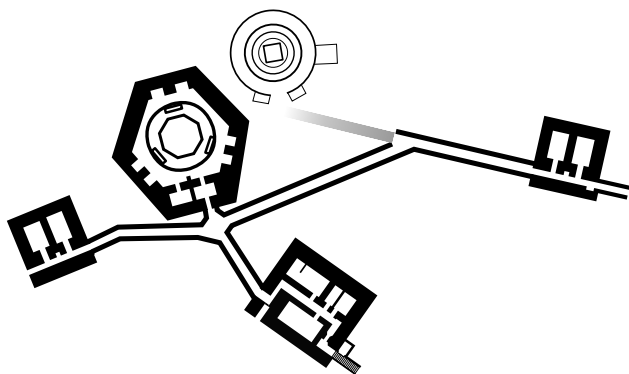

## Resistance Nest Millbrook

### 4.7cm Anti-Tank Gun Casemate

This bunker, which can be found on the sea wall adjacent to the cycle track and Old Station Café at Millbrook, Victoria Avenue, was something of a time capsule when reopened in 1985.

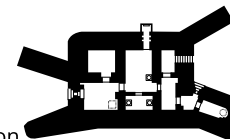

It has since been restored to pristine condition, and contains a rare 4.7cm Pak K36(t) Czech gun, along with a wealth of original fixtures and fittings, including a full set of air ventilation equipment. Keep a look out for the soldiers' names above their clothes pegs, gas alarm instructions, and the original wiring and electrical fittings - which are still in use.

 Nearest stops #3436/7  
Coronation Park E/W



## Strongpoint Corbiere

### M19 Fortress Mortar & Heavy Machine Gun Bunkers

This bunker is of great importance as it housed a rare type of fortress mortar. Owing to the complexity and cost involved, very few of these weapons were ever made, and the bunker is the only example of its type in Jersey.

Another interesting and unusual feature is the tunnel which links the 'M19' to a recently excavated heavy machine-gun bunker 100 yards away.

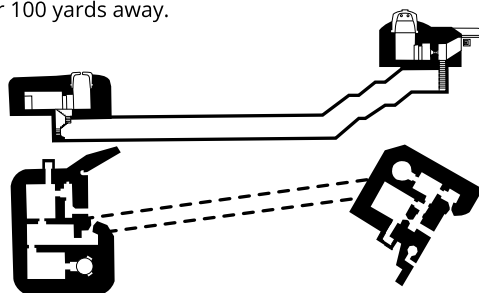

 Nearest stop #2545  
Corbière

### 10.5cm Coastal Defence Gun Casemate

This is the only coastal defence bunker in the Saint Ouen's Bay area to retain its original gun, and is practically complete.

At the sharp end is the 1918 vintage 10.5cm K331(f) weapon, which is actually French in origin, having been captured by the Germans in 1940, and subsequently converted to fortress use in the Channel Islands.

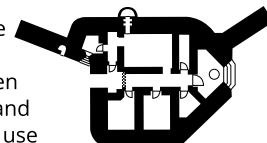

## Resistance Nest La Mare Mill

### Sechsschartentürm, Heavy Machine-Gun Turret Bunker

Visitors may access the interior of the cupola, equipped with a deactivated MG 34 machine-gun, and peer through the optics to see a landscape that has changed little since the Occupation. With steel cupolas up to 12 inches in thickness, these 'six-loopholed turret' bunkers once proliferated along the Atlantic Wall. This is one of the few surviving examples.

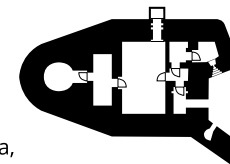

Car parking and access to the bunker is in Route du Moulin, beside the prominent German railway bridge and Bethesda Methodist Chapel.

 Nearest stop #3852  
Sunset Nurseries